



CRAFT
TIME

2

HOURS



**POPSICLE
STICK
HEXAGON
SHELF**

HERE'S WHAT YOU NEED TO GET STARTED...



**BOSTIK HOBBY
CRAFT GLUE**



**POPSICLE STICKS
(ABOUT 100)**



WOOD STAIN



PAINT BRUSHES

PROJECT SHEET

SAVE POPSICLE STICKS OVER SUMMER AND RECYCLE THEM HERE!

STEP 1. CREATE THE BASE

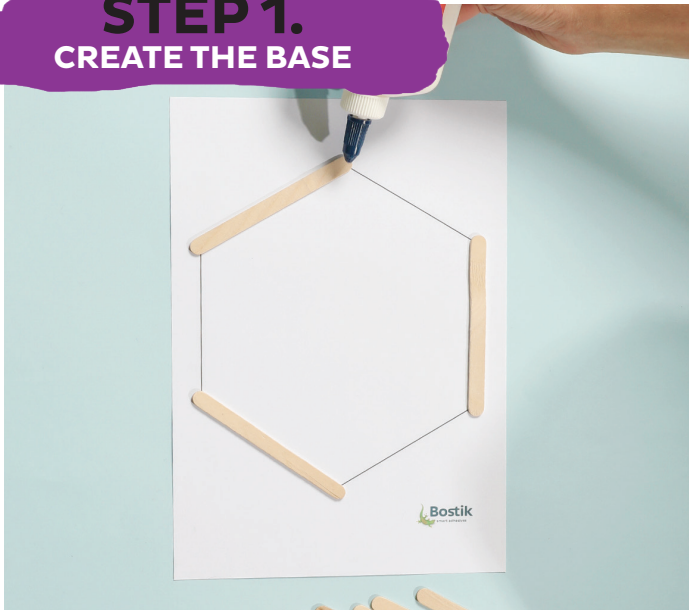

Add a drop of glue to both ends of three popsicle sticks and lay them as shown.

STEP 2. LAYER IT



Layer three more sticks to complete the hexagon.

STEP 3. RINSE AND REPEAT



Continue glueing and layering like this until your hexagon shelf is as deep as you'd like it to be. Allow the glue to dry.

STEP 4. PAINT IT



Cover the shelf in wood stain, ensuring you get the colour in between all of the popsicle sticks.

MADE IT?
SHARE IT!



SHOW US YOUR
CREATIONS AT
#IDEASTHATSTICK

 **Bostik**
smart adhesives

